

Owner's Manual

USB 2.0 Desktop/Laptop 1080p Webcam with Internal Microphone, LEDs and Lens Cover

Model: AWC-002

Este manual está disponible en español en la página
de Tripp Lite: tripplite.com

Ce manuel est disponible en français sur le site Web
de Tripp Lite : tripplite.com

Русскоязычная версия настоящего руководства
представлена на веб-сайте компании Tripp Lite по
адресу: tripplite.com

Dieses Handbuch ist in deutscher Sprache auf der
Tripp Lite-Website verfügbar: tripplite.com

WARRANTY REGISTRATION

Register your product today and be automatically entered to
win an ISOBAR® surge protector in our monthly drawing!

tripplite.com/warranty



TRIPP·LITE



1111 W. 35th Street, Chicago, IL 60609 USA
tripplite.com/support

Copyright © 2021 Tripp Lite. All rights reserved.
All trademarks are the sole property of their respective owners.

Package Contents

- AWC-002 USB 2.0 Webcam
- USB-A to USB-C Adapter
- Owner's Manual

Product Features

- Captures high-definition (HD) 1080p video at 30 fps (frames per second) and 2 MP (megapixel) images for livestreaming or conference calls
- 70° wide-angle lens reduces dead angles
- Advanced H.264 video compression ensures high-quality transmission
- Rotatable clip makes it easy to mount onto laptops or monitor screens
- Tripod threads allow mounting on a tripod for extra stability
- Built-in noise reduction microphone captures audio within 20 ft. to ensure clear communication and sound quality
- LEDs indicate webcam's on/off/active status to prevent accidental video feeds
- Movable lens cover provides extra privacy when needed
- USB-A to USB-C adapter included for versatility in port connection

Product Features

- Compatible with Windows and macOS operating systems, as well as Skype, Zoom and YouTube software
- Plug-and-play operation with no software required for easy, immediate installation

System Requirements

- USB-A or USB-C port
- Windows 7, 8, 10 or later
- macOS 10.10 or later
- Android 5.0 or above
- Chrome OS

Mounting Instructions

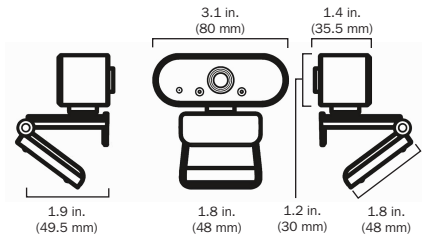

- 1) Open the clip base.
- 2) Mount the webcam to your monitor or laptop.
Note: Make sure the foot on the clip base is flush with the back of your monitor or laptop screen.
- 3) Rotate the camera to the desired angle.

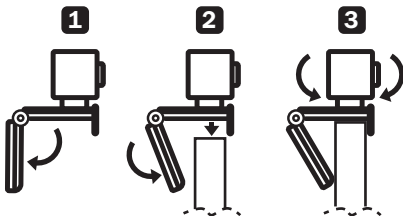

Note: Tripod threads at the bottom of the clip base allow you to mount the webcam on a tripod.

Connection/Installation

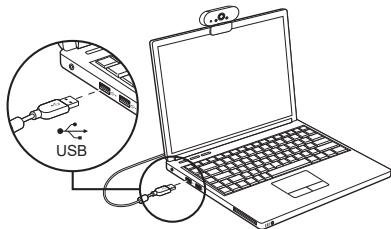

Plug the webcam into a USB-A or USB-C interface on your PC, laptop or TV STB. The webcam will install automatically in about 60 seconds.

Note: A USB-A to USB-C adapter is included for connecting the built-in USB-A cable to the USB-C port on your laptop or computer.

Video Calling

To take advantage of livestreaming or video calling, both you and the recipient must install video-calling applications (such as Skype or Zoom) and webcam hardware.

FAQ

Q: How do I know if my camera is recognized by the operating system?

A: Connect the webcam to a USB port and wait about one minute for it to install. To check if your computer's OS is recognizing the webcam, go to: Control Panel > System and Security > System > Device Manager

Q: How do I know if my video calling application is using my webcam?

A: All video applications include an option setting to review the audio and video device. While using the video application, review the following:

- The audio selection to ensure the webcam microphone is selected. If not, change the selection to AWC-002 webcam.
- The video selection to ensure the webcam is selected. If not, change the selection to AWC-002 webcam.

Q: How do I determine if the webcam is properly installed on my computer?

A: Windows: Go to: Computer Management > Device Manager > Cameras

A: macOS: Click the Finder icon on the Dock. From the Finder window sidebar, click Applications and open the Photo Booth app. Click the Camera dropdown from the Photo Booth toolbar. "USB 2.0 Camera" should be listed as the default webcam.

FAQ

Q: Why is my webcam not working with Skype or Facebook?

A: Software like Skype and Facebook often use the integrated webcam by default. To use the AWC-002 webcam, go to the software's video settings and select the AWC-002 webcam as the video source. For example, with Skype, go to Setting > Audio & Video to select the video source.

Q: What do the LEDs on my webcam indicate?

A: The red LED indicates the webcam is powered on.
The green LED indicates the camera is active.

Specifications

Pixel Size	2.8 μm x 2.8 μm
Operating Temperature Range	-4° to 140°F (-20° to 60°C)
Storage Temperature Range	-4° to 140°F (-20° to 60°C)
Relative Humidity	0% to 20% RH, Non-Condensing
Image Resolution	2 MP
Pixel Range	320 x 240, 640 x 480, 1280 x 720, 1920 x 1080
Frame Rate	30 fps
Lens Size	1/2.7 in.
Interface/ USB Specification	USB 2.0 (backwards compatible with USB 1.1)
Data Format	YUY2/MJPEG
Viewing Angle	70°
DC Voltage	5V
Current	200mA
Cable Length	4.8 ft. (1.45 m)

Warranty and Product Registration

3-Year Limited Warranty

Seller warrants this product, if used in accordance with all applicable instructions, to be free from original defects in material and workmanship for a period of three (3) years from the date of initial purchase. If the product should prove defective in material or workmanship within that period, Seller will repair or replace the product, at its sole discretion.

THIS WARRANTY DOES NOT APPLY TO NORMAL WEAR OR TO DAMAGE RESULTING FROM ACCIDENT, MISUSE, ABUSE OR NEGLIGENCE. SELLER MAKES NO EXPRESS WARRANTIES OTHER THAN THE WARRANTY EXPRESSLY SET FORTH HEREIN. EXCEPT TO THE EXTENT PROHIBITED BY APPLICABLE LAW, ALL IMPLIED WARRANTIES, INCLUDING ALL WARRANTIES OF MERCHANTABILITY OR FITNESS, ARE LIMITED IN DURATION TO THE WARRANTY PERIOD SET FORTH ABOVE; AND THIS WARRANTY EXPRESSLY EXCLUDES ALL INCIDENTAL AND CONSEQUENTIAL DAMAGES.

(Some states do not allow limitations on how long an implied warranty lasts, and some states do not allow the exclusion or limitation of incidental or consequential damages, so the above limitations or exclusions may not apply to you. This warranty gives you specific legal rights, and you may have other rights which vary from jurisdiction to jurisdiction.)

WARNING: The individual user should take care to determine prior to use whether this device is suitable, adequate or safe for the use intended. Since individual applications are subject to great variation, the manufacturer makes no representation or warranty as to the suitability or fitness of these devices for any specific application.

PRODUCT REGISTRATION

Visit triplite.com/warranty today to register your new Tripp Lite product. You'll be automatically entered into a drawing for a chance to win a FREE Tripp Lite product!*

*No purchase necessary. Void where prohibited. Some restrictions apply. See website for details.

Use of this equipment in life support applications where failure of this equipment can reasonably be expected to cause the failure of the life support equipment or to significantly affect its safety or effectiveness is not recommended.

Tripp Lite has a policy of continuous improvement. Specifications are subject to change without notice. Photos and illustrations may differ slightly from actual products.



1111 W. 35th Street, Chicago, IL 60609 USA
triplite.com/support